

BP15

SUB-PLATE



- Material: Cast Iron FC300(JIS) / GG30(DIN)
- Heat treated (Normalized)
- Alignment Bushing: SUJ2(JIS) / 100Cr6 (DIN), heat treated
- Threaded Insert: S45C(JIS) / CK45(DIN), heat treated
- MTP hole spacing: 50 ± 0.02
- Application: Modular quick change subplate, use with BP13.
- Features: Alignment bushing & thread insert at every hole location, easily adapts to standardized jig components.

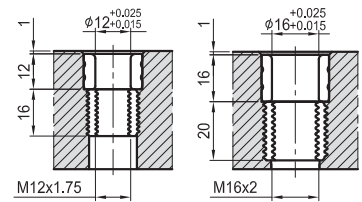
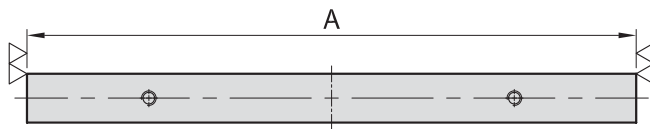
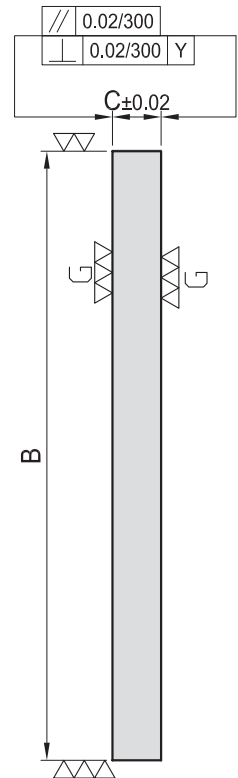
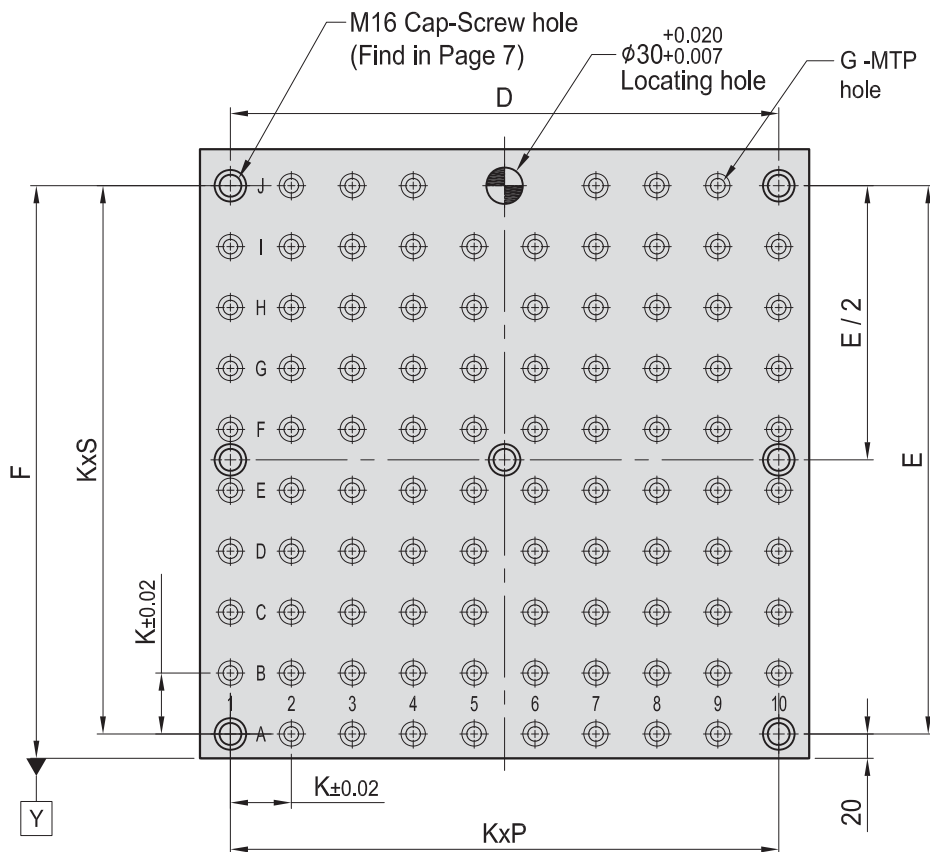

Figure G



MODEL NO.	A	B	C	D	E	F	K	P	S	G	MTP	Mounting holes	kg	MODEL NO.	A	B	C	D	E	F	K	P	S	G	MTP	Mounting holes	kg		
BP15-40400-0400-12	400	400	40	350	350	370	50	7	7	ø12	M12	58	5	42	BP15-40400-0400-16	400	400	40	350	350	370	50	7	7	ø16	M16	58	5	41
BP15-40500-0500-12	500	500		450	450	470		9	9			94	7	69	BP15-40500-0500-16	500	500		450	450	470		9	9		90	7	67	
BP15-40630-0630-12	630	630	40	580	580	600	50	11	11	ø12	M12	138	7	108	BP15-40630-0630-16	630	630	40	580	580	600	50	11	11	ø16	M16	138	7	105
BP15-50800-0800-12	800	800	50	750	750	770		15	15			250		220	BP15-50800-0800-16	800	800	50	750	750	770		15	15		246		215	

*Special Design Welcome !