

BP20

M/C ANGLE PLATE



- Material: Cast Iron FC300(JIS) / GG30(DIN)
- Heat treated (Normalized)
- Application: HMC / VMC
- Features: Ready to accept a hole pattern for your special jig.

BP

BPA

BC

CP

SU

PT

SVF

ALV

OK-
VISE

OTHER

Column
for
Technical
Data

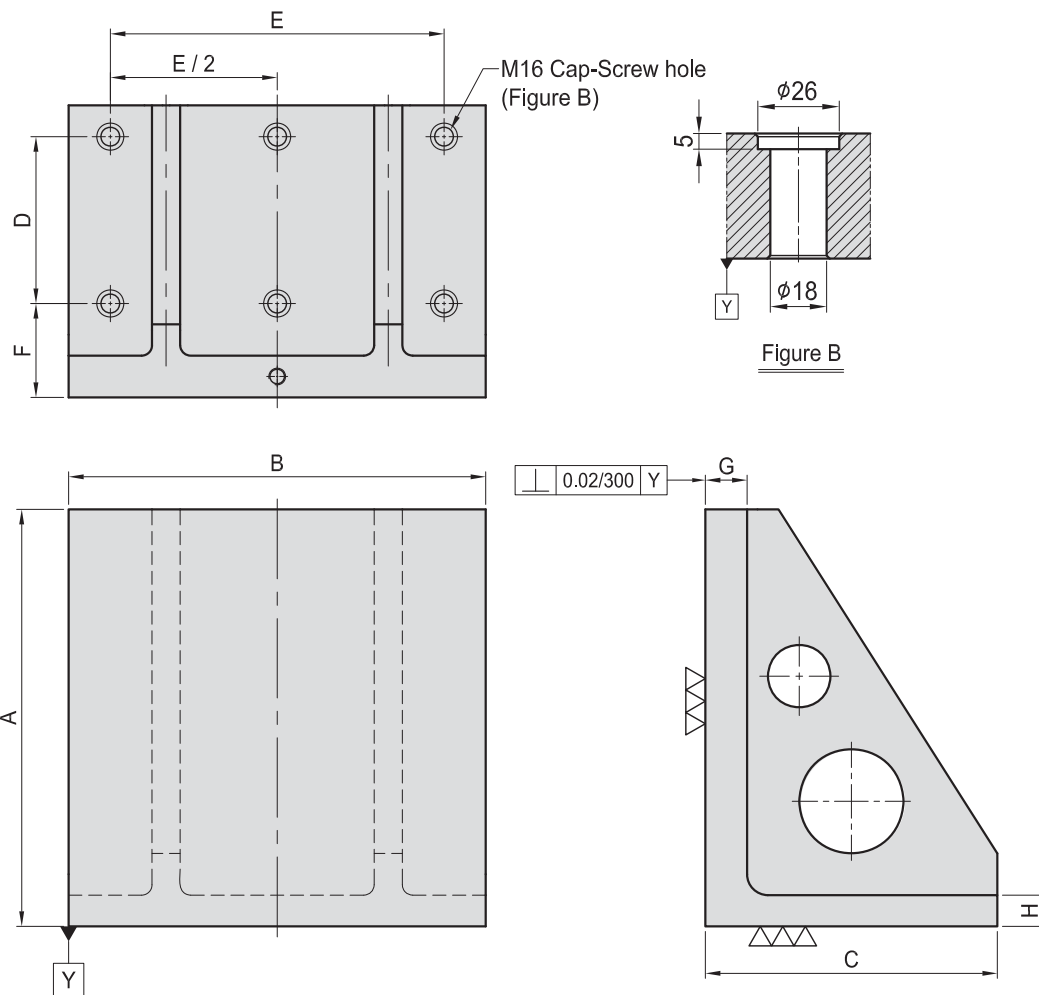

MODEL NO.	A	B	C	D	E	F	G	H	Mounting holes	kg
BP20-220300-0300	300	300	220	100	250	90	40	30	6	50
BP20-280400-0400	400	400	280	160	320					90
BP20-340500-0500	500	500	340	200	400	100	50	35	6	165
BP20-435630-0630	630	630	435	250	500					40
BP20-525800-0800	800	800	525	320	640	115	50	45	6	475

*Special Design Welcome !