



BP24

MC NARROW ANGLE PLATE

- Material: Cast Iron FC300(JIS) / GG30(DIN)
- Heat treated (Normalized)
- Alignment Bushing: SUJ2(JIS) / 100Cr6(DIN), heat treated
- Threaded Insert: S45C(JIS) / CK45(DIN), heat treated
- MTP hole spacing: 50 ± 0.02
- Application: HMC / VMC.
- Features: Alignment bushing & thread insert at every hole location, easily adapts to standardized jig components.

- BP
- BPA
- BC
- CP
- SU
- PT
- SVF
- ALV
- OK-VISE
- OTHER
- Column for Technical Data

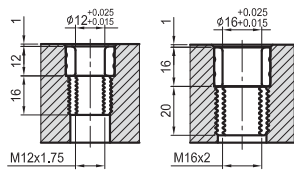
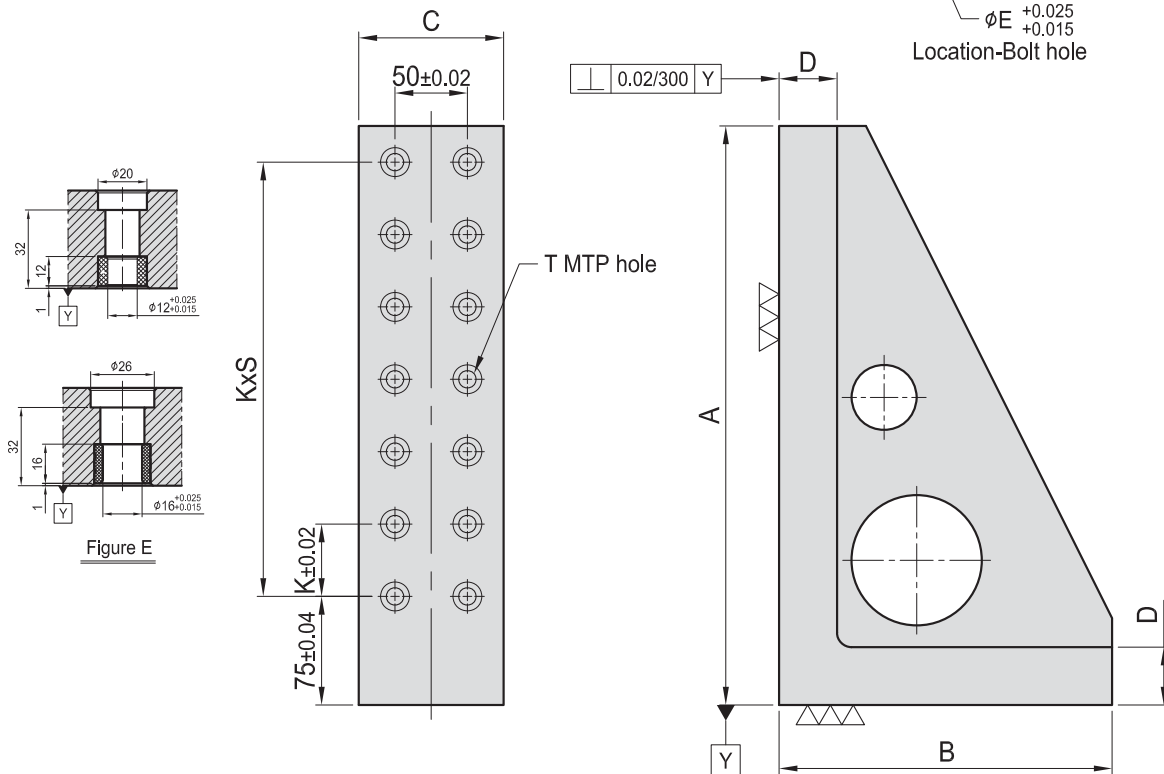
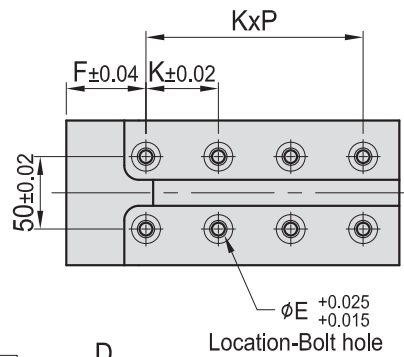

Figure T



MODEL NO.	A	B	C	D	E	F	K	P	S	T	MTP	Mounting holes	kg
BP24-180100-0300-12	300	180						2	4			6	12
BP24-230100-0400-12	400	230	100	40	12	55	50	3	6	$\phi 12$	M12	8	19
BP24-280100-0500-12	500	280						4	8			10	23
BP24-180100-0300-16	300	180						2	4			6	13
BP24-230100-0400-16	400	230	100	40	16	55	50	3	6	$\phi 16$	M16	8	20
BP24-280100-0500-16	500	280						4	8			10	24

*Special Design Welcome !