

# PT31

## SHOULDER BOLT

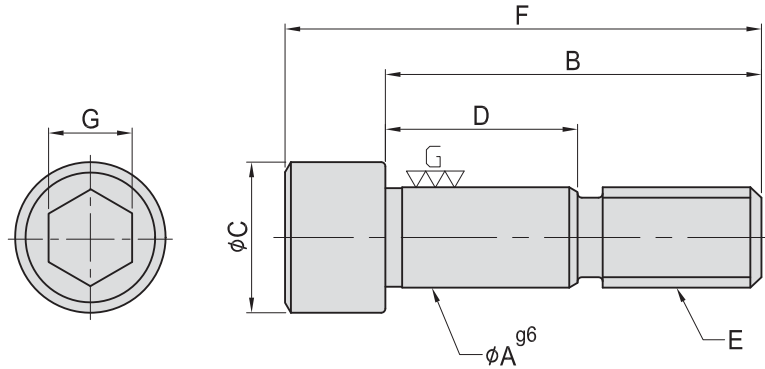

- Material : SCM435(JIS)/34CrMo4(DIN)
- Heat treated : HRC 32°~38°
- Application : Position & fasten this accurately ground bolt.

MODEL NO.	A	B	C	D	E	F	G	kg
PT31-1245	12	45	18	23	M12	57	10	0.053
PT31-1255		55		33		67		0.060
PT31-1265		65		43		77		0.070
PT31-1275		75		53		87		0.078
PT31-1655	16	55	24	28	M16	72	14	0.120
PT31-1665		65		40		82		0.140
PT31-1675		75		50		92		0.150
PT31-1688		88		68		105		0.165