

PT07

CLAMPING STUD

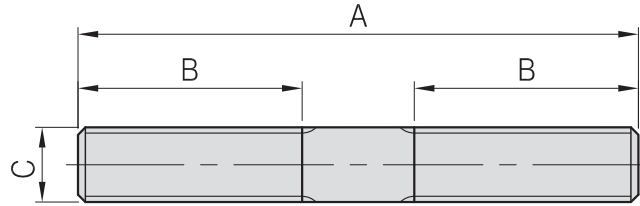

- Material : S45C(JIS) / CK45(DIN)
- Heat treated : HRC 22°~28°
- Surface finish : Black Oxide.



BP

BPA

BC

CP

SU

PT

SVF

ALV

OK-
VISE

OTHER

Column
for
Technical
Data

MODEL NO.	A	B	C	kg
PT07-08050	50	22	M8 P=1.25	0.020
PT07-08075	75			0.030
PT07-08100	100	38		0.040
PT07-08125	125			0.050
PT07-08150	150	50		0.060
PT07-08175	175			0.070
PT07-08200	200			0.080
PT07-08250	250			0.098
PT07-10050	50	22	M10 P=1.5	0.030
PT07-10075	75	30		0.042
PT07-10100	100	38		0.055
PT07-10125	125			0.070
PT07-10150	150	50		0.090
PT07-10175	175			0.108
PT07-10200	200			0.123
PT07-10250	250			0.154
PT07-12050	50	22	M12 P=1.75	0.040
PT07-12075	75	30		0.060
PT07-12100	100	38		0.080
PT07-12125	125			0.100
PT07-12150	150	50		0.125
PT07-12175	175			0.155
PT07-12200	200			0.160
PT07-12300	300			0.240
PT07-14050	50	22	M14 P=2.0	0.060
PT07-14075	75	30		0.090
PT07-14100	100	38		0.120
PT07-14125	125			0.150
PT07-14150	150	50		0.180
PT07-14175	175			0.210
PT07-14200	200			0.240
PT07-16050	50			22
PT07-16075	75	30	0.120	
PT07-16100	100	38	0.145	
PT07-16125	125		0.180	
PT07-16150	150	50	0.230	
PT07-16175	175		0.276	
PT07-16200	200		0.290	
PT07-16250	250		0.350	
PT07-16300	300	0.450		
PT07-16400	400	100	0.580	
PT07-16500	500		0.700	

MODEL NO.	A	B	C	kg	
PT07-18050	50	22	M18 P=2.5	0.100	
PT07-18075	75	30		0.150	
PT07-18100	100	38		0.200	
PT07-18125	125			0.220	
PT07-18150	150	50	0.300		
PT07-18175	175		0.320		
PT07-18200	200	65	0.360		
PT07-18300	300	80	0.600		
PT07-20050	50	22	M20 P=2.5	0.125	
PT07-20075	75	30		0.170	
PT07-20100	100	38		0.230	
PT07-20125	125			0.275	
PT07-20150	150	50		0.360	
PT07-20175	175			0.437	
PT07-20200	200			0.450	
PT07-20250	250			0.550	
PT07-20300	300	80		0.700	
PT07-20400	400	100		0.880	
PT07-20500	500		1.100		
PT07-22050	50	22	M22 P=2.5	0.150	
PT07-22075	75	30		0.223	
PT07-22100	100	38		0.300	
PT07-22125	125			0.373	
PT07-22150	150	50		0.448	
PT07-22175	175			0.522	
PT07-22200	200			0.597	
PT07-22250	250			0.746	
PT07-22300	300	80		0.895	
PT07-22400	400	100		1.194	
PT07-22500	500			1.492	
PT07-24050	50	22		M24 P=3.0	0.177
PT07-24075	75	30			0.266
PT07-24100	100	38			0.355
PT07-24125	125		0.443		
PT07-24150	150	50	0.533		
PT07-24175	175		0.620		
PT07-24200	200		0.710		
PT07-24250	250		0.880		
PT07-24300	300	80	1.065		
PT07-24400	400	100	1.420		
PT07-24500	500		1.775		